

1460 OVERLOOK

LAFAYETTE, CO

INDUSTRIAL SPACE
FOR SALE
\$6,350,000



INDUSTRIAL SPACE
FOR SALE
\$6,350,000

NEW CONSTRUCTION
READY FOR
OCCUPANCY!

ADDITIONAL FEATURES

- Skylights in shop
- Roof is 60 EPDM with R19 insulation
- Precast concrete
- E470 visibility
- Furniture Available

TOTAL PROJECT SIZE

56,185 SF

SITE SIZE

3.52 Acres

OFFICE

First Floor: 7,000 SF
Second Floor: 7,000 SF (unfurnished)

CLEAR HEIGHT

18'

SPINKLERED

Wet System, 100% coverage

LOADING DOORS

15 drive-In Doors, (14'x12')

ZONING ID

PUD - M-1

PROPERTY TAX

\$79,840.92

PARKING

78 Stalls

POWER

1,000 amps, 277/480 volt 3 phase 4 wire

HVAC

5 rooftop units, 46.5 tons total for offices, 5 evaporative coolers in shop

HEATING

5 rooftop gas units for office, 12 gas radiant heaters in shop

LIGHTING

Metal halide exterior, high bay fluorescent in shop

FOR MORE
INFORMATION
PLEASE
CONTACT

Jeremy Kroner

Senior Associate
720.528.6455
jeremy.kroner@cbre.com
www.cbre.com/jeremy.kroner

Frank Kelley

Senior Vice President
720.528.6344
frank.kelley@cbre.com
www.cbre.com/frank.kelley

CBRE
CB RICHARD ELLIS

1460 OVERLOOK

LAFAYETTE, CO

INDUSTRIAL SPACE
FOR SALE
\$6,350,000

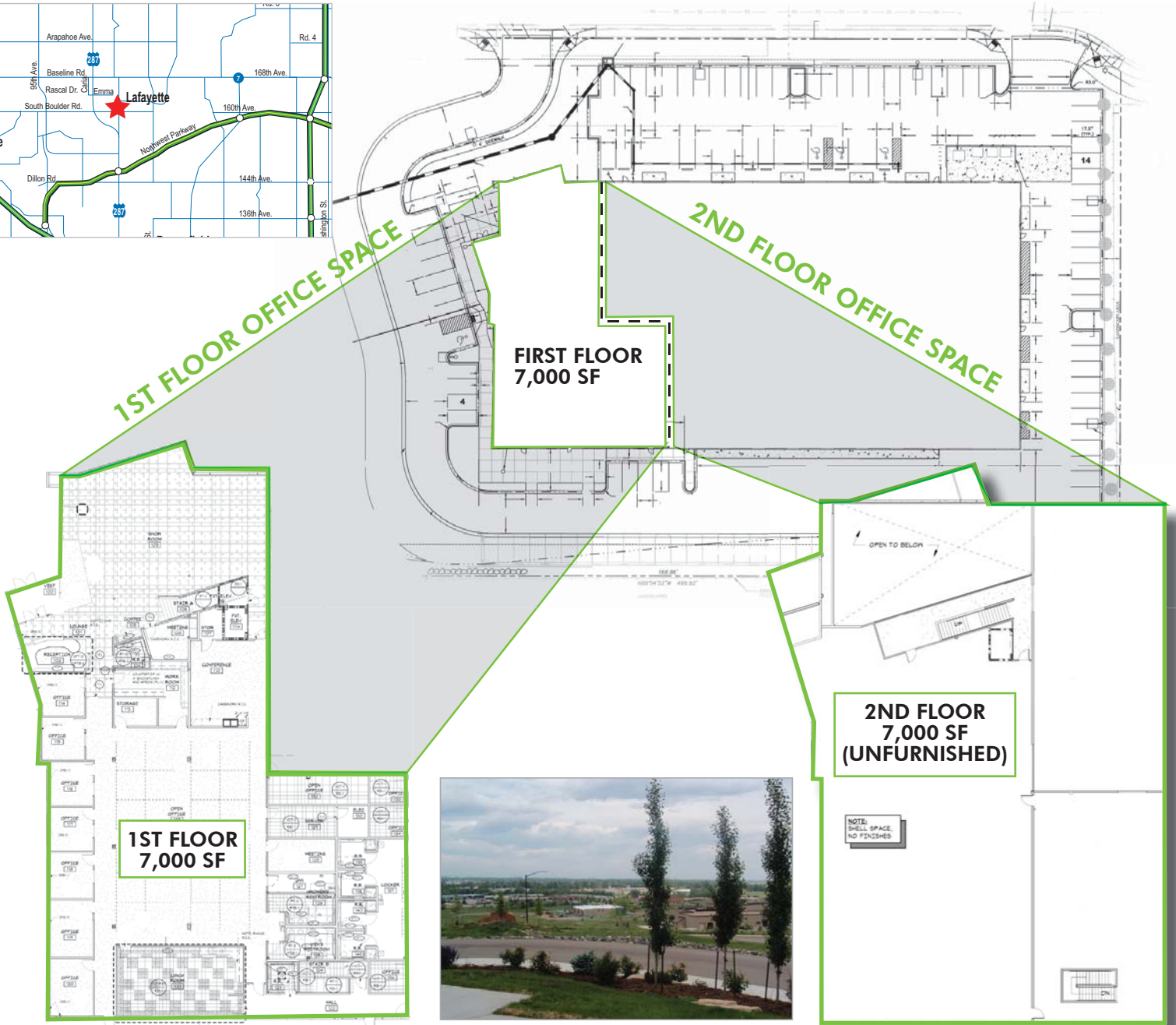
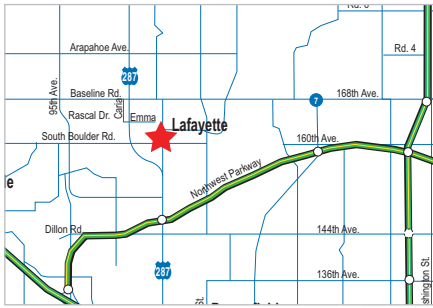

FOR MORE
INFORMATION
PLEASE
CONTACT

Jeremy Kroner

Senior Associate
720.528.6455
jeremy.kroner@cbre.com
www.cbre.com/jeremy.kroner

Frank Kelley

Senior Vice President
720.528.6344
frank.kelley@cbre.com
www.cbre.com/frank.kelley

CB Richard Ellis | 8390 E. Crescent Parkway | Suite 300 | Greenwood Village, CO 80111 | www.cbre.com/denver

© 2009 CB Richard Ellis, Inc. This information has been obtained from sources believed reliable. We have not verified it and make no guarantee, warranty or representation about it. Any projections, opinions, assumptions or estimates used are for example only and do not represent the current or future performance of the property. You and your advisors should conduct a careful, independent investigation of the property to determine to your satisfaction the suitability of the property for your needs.

CBRE
CB RICHARD ELLIS